



p.0050712

Dampers up to approx. 0.8 m²
Open/Close actuator (AC/DC 24 V)
Control by single-pole contact

Application

For the operation of air dampers that perform safety functions (e.g. frost and smoke protection, hygiene, etc.).

Mode of operation

The LF... actuator moves the damper to its normal working position while tensioning the return spring at the same time. If the power supply is interrupted, the energy stored in the spring moves the damper back to its safe position.

Wiring diagram

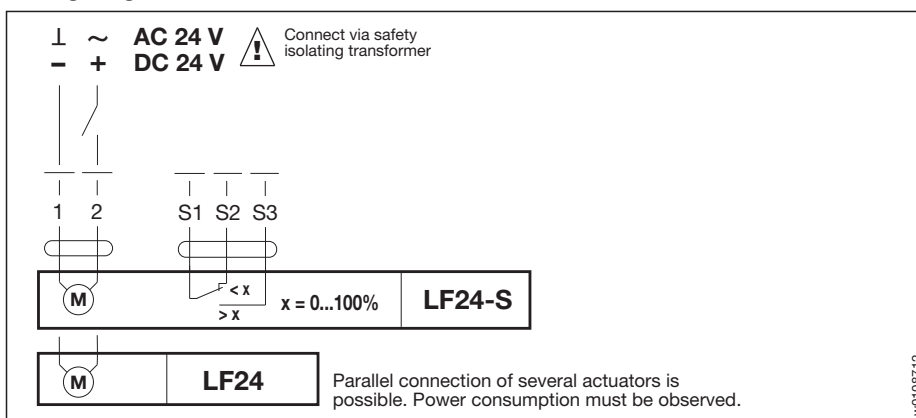

w0108712

Product features

Simple direct mounting on the damper spindle by universal spindle clamp. An anti-rotation device is supplied to prevent unwanted rotation of the whole unit.

Mechanical angle of rotation limiting adjustable with built-in stop.

High functional reliability

The actuator is overload proof, needs no limit switches and halts automatically at the end stop.

Flexible signalling 0...100% \triangleleft , with adjustable auxiliary switch (LF24-S only).

Adjusting the auxiliary switch LF24-S, page 6

Mounting accessories, page 11

Mounting instructions, pages 13...15

Important: Read the notes about the use and torque requirements of the damper actuators on page 3.

Technical data	LF24, LF24-S
Nominal voltage	AC 24 V 50/60 Hz, DC 24 V
Nominal voltage range	AC 19.2...28.8 V, DC 21.6...28.8 V
For wire sizing	7 VA (I _{max} 5.8 A @ 5 ms)
Power consumption	
– motoring	5 W
– holding	2.5 W
Connecting cable	– motor 1 m long, 2 x 0.75 mm ² – auxiliary switch (LF24-S) 1 m long, 3 x 0.75 mm ²
Auxiliary switch (LF24-S)	1 x SPDT 6 (1.5) A, AC 250 V <input type="checkbox"/>
– Switching point	adjustable 0...100% \triangleleft
Direction of rotation	selected by mounting L/R
Torque	– motor min. 4 Nm (at rated voltage) – spring return min. 4 Nm
Angle of rotation	max. 95° (adjustable 37...100% \triangleleft with built-in mechanical stop)
Running time	– motor 40...75 s (0...4 Nm) – spring return \approx 20 s @ -20...50 °C / max. 60 s @ -30 °C
Sound power level	motor max. 50 dB (A), spring \approx 62 dB (A)
Service life	min. 60 000 operations
Position indication	mechanical
Protection class	\diamond (safety extra-low voltage)
Degree of protection	IP 54
Ambient temp. range	-30...+50 °C
Non-operating temp.	-40...+80 °C
Humidity test	to EN 60730-1
EMC	CE according to 2004/108/EEC
Low Voltage Directive	CE according to 2006/95/EEC
Maintenance	maintenance-free
Weight	1400 g

Dimensions

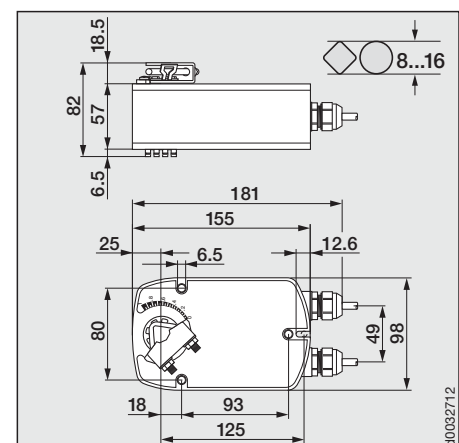

d0032712